



PC touch-screen control

All Haescomm Emergency Voice Communications Systems (EVCS) are designed to comply with the requirements of BS5839-9:2011 for use as a fire telephone (FT), disabled refuge system (DRS) or as a combined system when both fire telephones and disabled refuge points are required.

Key Features

- Touch-screen PC panel with solid state drive
- Integrated telephone handset
- Full status indication
- Extensive logging of all calls and faults
- Integrated assist call with acknowledge, meeting BS8300
- Simply import graphics and add buttons in the editor
- COTS not bespoke software
- 3A EN54-4:A2 PSU



The HC-Commander is a replica of the master station (which still must be fitted) and allows hi-resolution maps or graphical representations to be displayed with buttons overlaid representing the EVCS outstations. Area buttons allow screens to be linked enabling overview and zoom screens to be quickly implemented.

The application contains full editing capabilities, password protected, allowing the user or engineer screens of bitmaps to be imported. Providing a COTS approach to the GUI with maximum flexibility without all the issues attached with bespoke software.

Technical specifications

Screen resolution	1920 x 1080
Screen size	21.5" full colour TFT, capacitive multi-touch
PC CPU	Celeron N2930 1.8GHz
PC memory	4GB DDL 1600MHz
AC input	230vac +/- 10% 50/60Hz
Internal supply	27v dc, monitored; open, short, fuses, high impedance
Protection	Deep discharge, short, thermal
Battery type	2 x 12v 7Ah VRSLA
Mains fuse	240v 1A HRC
Battery fuse	3A

Models

HC-COMMANDER	PC touch-screen control
--------------	-------------------------

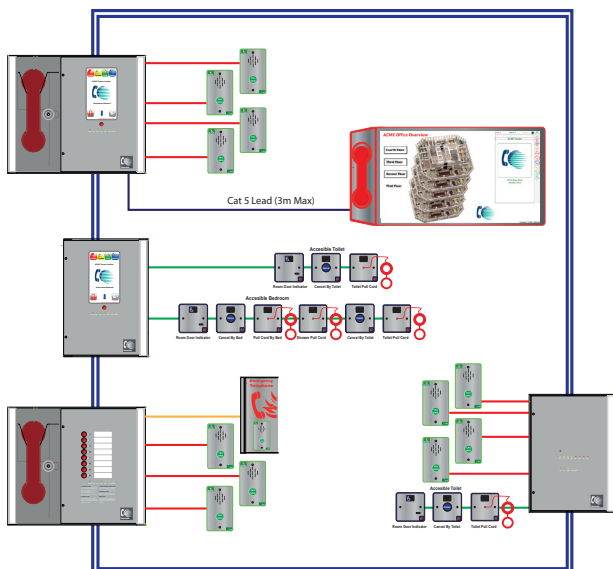

Cable Key

- 1 off 2 core 1.5mm CSA
Standard rated fire cable —————
- 1 off 2 core 1.5mm CSA
Enhanced rated fire cable —————
- 1 off 2 core 1.0mm CSA
Standard PVC minimum —————
- Network 2 off 2 core
1.5mm CSA. Standard fire
rated unless Type A or Type
C outstations are used
then it must be Enhanced —————