



## System expander panel

All Haescomm Emergency Voice Communications Systems (EVCS) are designed to comply with the requirements of BS5839-9:2011 for use as a fire telephone (FT), disabled refuge system (DRS) or as a combined system when both fire telephones and disabled refuge points are required.

### Key Features

- Fully compliant to BS5839-9
- Integrated assist-call with acknowledge, meeting BS8300
- 1.5A EN54-4:A2 PSU
- Full duplex operation
- Wall mount enclosure
- Full status indication
- In-built networking



The Haescomm HC-EX8 system expander can accept up to eight lines of outstation, (Type A fixed phones, Type B refuge hands free points, emergency assist alarm point or jack points in Far East and Middle East applications) as required.

Lines auto identify by flashing Red for EVCS calls, Blue for assist calls or Green for connected calls as detailed in BS5839-9:2011.

The HC-EX8 has in-built networking allowing it to form one of the 64 panels on a Haescomm network installation, or allowing a total of 512 outstations to be accommodated. Each panel on the Haescomm network can be a master station or system expander.

The display on the front of the HC-EX8 gives the current call or fault status of each line of the local panel, aiding fault finding.

### Technical specifications

AC input	230vac +/- 10% 50/60Hz
Internal supply	5v, 16v, 27v dc, monitored; open, short, fuses, high impedance
Protection	Deep discharge, short, thermal
Battery type	1 x 12v 7Ah VRSLA
Mains fuse	240v 1A HRC
Battery fuse	750mA PTC
Charge current	400mA
Inputs	2-8 in 2 line blocks, short to use, end of line = 10KΩ
Outputs	1 x fault, 1 x in use, volt free relay, 30Vdc 1A
Network cables	2 x 2 core, 1 or 1.5mm enhanced fire resistant (refer to BS5839-9:2011 for exceptions). Max 500m
Dimensions	300mm H x 220mm W x 95mm D

### Models

HC-EX8-8	8 line system expander
----------	------------------------

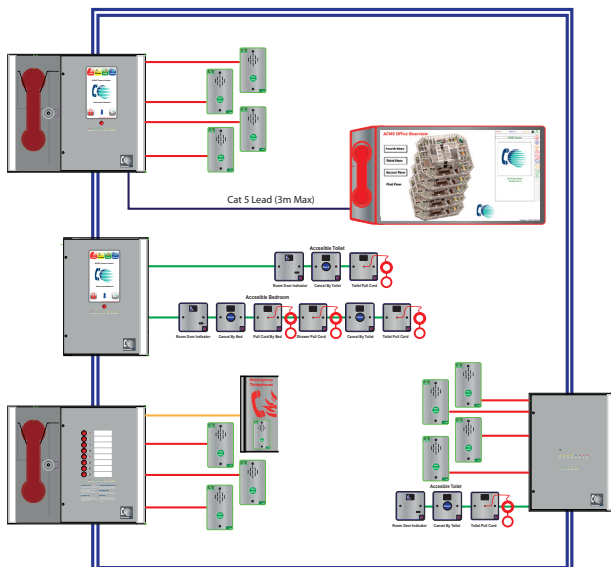

### Cable Key

- 1 off 2 core 1.5mm CSA Standard rated fire cable (Red line)
- 1 off 2 core 1.5mm CSA Enhanced rated fire cable (Yellow line)
- 1 off 2 core 1.0mm CSA Standard PVC minimum (Green line)
- Network 2 off 2 core 1.5mm CSA. Standard fire rated unless Type A or Type C outstations are used then it must be Enhanced (Blue line)